



# The Mountain GAZETTE

© 2019, Train Mountain

An Official Publication of the Train Mountain Institute and TM Railroad—Issue Vol. #4 Issue #10 June 2019

## June

I know many of you are not on Facebook but that you do check into the club website occasionally. Well either way you have probably noticed that we have had TRAINS, TRAINS, TRAINS here almost every day. It sure is fun seeing our members enjoy the park. Quentin's Dream was to have a place where the members could come and go as their schedule permitted and be allowed full access to what the members helped to build. Remember that little speech you got when you asked about membership, it went something like "with your membership you get 24 - 7, 365 access". The only added fare is for meets. I think he would be very pleased with this past month's activities.

Tourist season is in full swing and Barbara and crew are handling the load. They can always use more help. Barbara has a couple of folks that help relieve her in the Visitor Center office and also an extra train crew member or two. But they are still looking for more help.

In this issue I am posting a 'Letter to the Editor' and my reason for doing this is simple. This individual is not a committee chair or a BOD member but spends a great deal of time here working very hard. This individual has some comments that need to be heard and be available for comment. Please look for the Heading 'Letter to the Editor'.

A reminder that the club's very simple Rules of the Road are enforce 24 - 7. They are NOT Meet rules or Work Week rules, they are TRAIN MOUNTAIN RAILROAD PARK RULES at all times. Please, please, please abide by them so we can all have a very safe and fun visit to the park.

Next up is the always fun Operations Meet. From the emails I've seen from the committee it looks like this years meet will be the best ever. Stay tuned, the next issue will be all things OPS meet!

### 2018 TRIENNIAL VIDEO AVAILABLE NOW

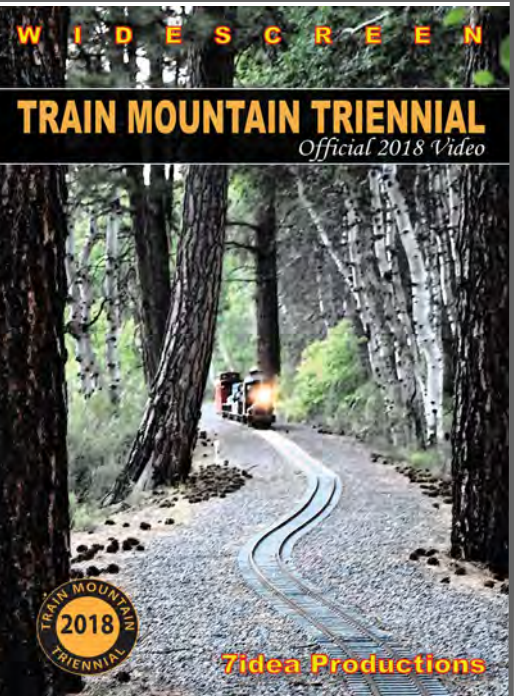

**Click Here to Purchase Online  
Or Go To:**

<https://trainmtn.org/tmrrmembers/videosales1.aspx>



### Join Train Mountain Now!

Register or Join - [https://trainmtn.org/tmrrmembers/Member\\_Portal.aspx](https://trainmtn.org/tmrrmembers/Member_Portal.aspx)

## From the Desk of TMRR President June 2019

### Jeff Mills, President TMRR

By the time this article is published, the 2019 Operations Meet will have started. Special thanks to the OPS Meet Committee and the TMRR Board of Directors is in order. The committee has worked since the close of the 2018 OPS meet to make this year's meet a great experience for everyone. There will be quite a few new facets to this year's meet. One of which is a Point System for freight operations, factoring in distance, as well as how many cars, are moved. There will be more prizes awarded this year, so get geared up and be as efficient as you can. We will be making an effort to get people without equipment on train crews. When we ask to add crew members, please be ready to do so. Many privately-owned freight cars have been loaned to us. These loaned cars make our operations as realistic as possible. Please treat all the cars used in freight operations as if they were yours. Our expectation is this should be an enjoyable and memorable meet for all.

Work on the Blue Mountain Coal structure has begun, led by Roger Rude and Danny Chamrad with Luke Conner and other Boy Scouts as laborers. Another structure needing restoration is the Coal Tipple at the Fuel Yard. Please contact Bill Kludt in the Carpentry Shop if you can participate in either of these projects.

The Radio Communication Committee has been appointed. The members are Dick Miller, Chris Novara, Paul Jorgenson, Dave White, Steve Passmore, Nathan McCauley, with Richard Peterson as TMRR Board Representative. This committee will be working on improving radio communications across the entire TMI property and ensuring FCC licenses are in place and their regulations are followed. This committee is important to the operation of TMRR. If you have suggestions or comments for this committee, please contact any of these members or me. Many of you have come to know one of our younger members, Luke Connor. Luke is in the process of becoming an Eagle Scout. This is the highest rank in Scouting and most scouts do not achieve this honor. As part of this goal, Luke must plan, manage, fund and complete a Community Service project. We are fortunate Train Mountain was chosen by Luke to fulfill this requirement. He is going to build new Pine Straw boxes to replace the old rickety ones we currently try to use. If he asks for your help with this project, please do what you can to assist him. It's an important one and we will all benefit from his success.

On the subject of raking and hauling pine straw and forest debris, we have most of the South side in good shape but a few areas still need some attention: DeBroi Winery; Young's Town Spur; Appendix Yard and Anaheim Siding. The North side tracks are mostly clear but much of the right-away still needs raking. Volunteers to get this work accomplished are always appreciated.

Last meet, I did a demonstration in the safe use of the Fire Tools supplied in the Fire Gondolas. Tom Watson made a video of it and you can find it on YouTube.com. Search "Videos by Tom Watson". While this video was not scripted and done "off the cuff", it turned out well and gets many basic safety points across. Please take the time to view this video as it will improve safety with these basic fire-fighting tools and our first response to any fire threat. We have three board positions open this year. If you are interested in serving on the TMRR Board, please contact John Cooper TMRR Board Vice President. These are important positions and make Train Mountain Railroad run bigger, better and safely.

The Visitor Center is getting busier as the weather improves. There have been more large groups of visitors as the schedule printed in the last Gazette shows. We always need volunteers for the Visitor Center to serve as Docents and Tour Train Crews. Your work will result in financial benefit to TMI and thus to TMRR. **The Visitor Center operated for 23 days in May, welcomed 372 Visitors (adults and children) and collected \$1,573.00 in donations. That averages \$68.40 per day and we hadn't even gotten to the big tourist season!** These docent jobs are low-mobility friendly and make a huge difference to our visitors. All interested members, please contact Barbara Ward or Dick Miller.

Remember to **log all your volunteer hours**, either online or your individual log sheet and log them like a lawyer would! Your time has value because our accumulated Volunteer hours make a big difference when we apply for

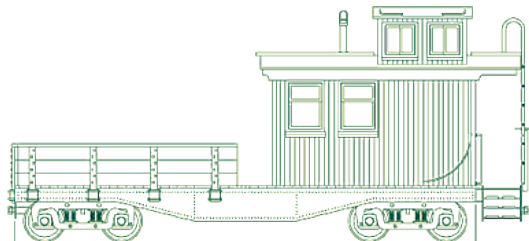

**Register to attend a Train Mountain Meet Now!**

## Greetings from Joyce at the front office:

Except for the last couple of days which have been unusually cool, June has been mostly warm to hot during the days, but still good and chilly at night.

Now that school is out and people have picked up the travel bug, visitor traffic has increased dramatically. Barbara Ward, Sabra Rickman, Marcia Furseth and Pam Panzik have been busy. David Savage, Russ Wood, Leonard Houpt, Rodger Rude, Bill Dobbs,, the Rickmans and others have been doing great at rail tours and/or helping with scheduled group events. Barbara Ward can use all of the volunteer help she can get in the Visitor Center and more volunteers are needed to engineer and conduct on the trains.

You may see kitty Charlie just about anywhere on the south side of the Train Mountain property. He runs to greet as many visitors and members as he can and one might see him at Central Station, Crisp Yard, down at Blue Caboose, at the Backshop, at the Carpentry Shop, up at the full scale equipment by the front gate daily, and even at Klamath & Western Railroad on Saturdays. Yup, he does get around! But, he still likes to come into the business office for a good and well-deserved afternoon nap.

Maggie, our more timid kitty hangs out mornings in the office but now that there is lot more foot traffic, she prefers the quiet of the upstairs and spends most of the afternoon hanging out up there. The Operations Work Week and Meet is fast approaching. It will be fun.

A special thank you to all volunteers who have helped with the school field trips and other special events like the Chiloquin Fire and Rescue picnic, GAR Civil War Ladies event and more. There are more special group events scheduled between now and into September. We can always use volunteer help with those. Members may ask to receive the group events calendar by calling me at 541-783-3030.

Membership including all family members is now at 711 and climbing.

I don't seem to have much more to say for this month except for some reminders and instead of being too repetitive, you can read my article in last month's Gazette for those.

It will be great to see those coming to the Ops Meet and anyone who is coming at other times during the summer season.

Joyce



**Register to attend a Train Mountain Meet Now!**

**The Mountain Gazette**

Page:3

**June 2019**



## ELECTIONS 2019!

The Board of Directors of Train Mountain Railroad Inc., the Social and Recreational club component of Train Mountain which primarily operates meet events for its members, will have three out of seven Director positions to be filled later this summer through voting of the general membership occurring between August 5, 2019 and August 19, 2019.

Directors shall be members of TMRR. Nominees must have exhibited an interest in and commitment to the purposes of Train Mountain Railroad and must have expertise in areas relevant to the needs of the organization.

To be considered for nomination, submit a written or e-mailed application addressing, as you see fit, the following:

- Why you are interested in the position of Director
- Experience and past contributions to TMRR
- Areas of expertise which might assist TMRR
- Other factors which you believe to be relevant.
- A current photo (jpeg or similar preferred) is encouraged.

The application will be reviewed by the Nominating Committee and, if nominated, a summary of up to 300 words will be published with the ballot.

**IMPORTANT:** To be on the ballot a qualified member must be nominated for election *by the Board*. The Board will accept applications directed to Mr. John Cooper, Vice-President TMRR, to be received by him not later than June 30, 2018. The By-Laws do not allow write-ins at the time of the election.

When elected, a Director is seated for a three-year term. For further background information consult the By-Laws and other relevant documents which are posted on the web site. Talking with current Directors is also encouraged!

FYI: Current Board Information as of April 2019:

<b>NAME</b>	<b>ELECTED</b>	<b>VACATES</b>	<b>Position 2018</b>
<b><i>Dick Peterson</i></b>	<b>2016</b>	<b>2019</b>	<b><i>Secretary</i></b>
<b><i>Joe Simon</i></b>	<b>2016</b>	<b>2019</b>	<b><i>Member at Large</i></b>
<b><i>David Waterstreet</i></b>	<b>2016</b>	<b>2019</b>	<b><i>Treasurer</i></b>
John Cooper	2017	2020	Vice President
Danny Chamrad	2018	2021	Member at Large
Jeff Mills	2018	2021	President
Tom Watson	2018	2021	Member at Large

**Register to attend a Train Mountain Meet Now!**



## Sierra Service Project (SSP)

SSP is a church oriented public service organization of young people, with headquarters in Sacramento, CA. Every summer SSP groups travel to AZ, NV, CA, OR, etc. as services are requested.

They center upon Native American communities and work on both public and private projects, like building, cleaning, clearing and painting. SSP members (who range in age from 14 to mid 20's) will be at TMRM for six weeks from June 30 to August 13, 2019.

Our first group last summer painted the "wooden" yellow snow plow, cleared brush and hauled many loads to the burn area.

**Please wave at them and thank them**, as you see them either painting with Jim Rickman or brushing with Frank Bartholomew.

### 2019 Train Mountain Train Meet Schedule

	Polar Bear Train Meet	Spring Awakening Train Meet	Narrow Gauge Train Meet	Operations Train Meet	August Train Meet	Big Build Train Meet	Fall Colors Train Meet
Work Week	none	4/27 to 5/2	5/25 to 5/30	6/29 to 7/3	8/3 to 8/8	8/31 to 9/5	none
Meet	1/18 to 1/21	5/3 to 5/5	5/31 to 6/2	7/4 to 7/7	8/9 to 8/11	9/6 to 9/8	10/11 to 10/14

In addition to our regular Tourist Rail Tours we also do many special interest group tours. If you can come and help, please do. Please call the office 541-783-3030 and let them know what dates you can help. Thanks for your support.



**Register to attend a Train Mountain Meet Now!**

## **Letter to the Editor**

### **The Case for “Biennials” - by Pam Williams**

With a stupendous Triennial behind us and the money already spent, it might be time to discuss the case that can be made for replacing the Triennial with a new option.

The Triennial was created by Train Mountain founder, Quentin Breen in 2003. Previously the LALS (Los Angeles Live Steamers) hosted an IBLS (International Brotherhood of Live Steamers) International meet at LALS every 5 years. Those meets did not charge registration fees. Their sponsorship ended in 2000 because they ran out of room to hold all the participants. That year, the event was run by Quentin Breen's Club members for the first time at Train Mountain. They required a “realistic” registration fee for the first time. It was also decided every 5 years was too long between meets so it became the Triennial in 2003, held every 3 years.

This shows there has been a tradition of change for the sake of the hobby, the venue and the enthusiasts.

How many of us had a friend or heard of someone who had been planning to attend the 2018 Triennial for years right up until the last minute? There was an illness, an accident, a car breakdown, or some other not-to-be ignored problem preventing them from attending this monumentally popular but infrequent event. I heard about plenty of them.

Despite those instances, 2018's event had another record turnout. With a fantastic crew of volunteers and a great Triennial Coordination team, this event was almost (or perhaps was!) too big to handle effectively. In 2018, we ran out of parking spaces for trains in addition to car space for both attendees and day visitors.

A more frequent event should alleviate that issue. We have learned, with popularity comes growth. There is no reason to believe we won't still have plenty of trains and visitors at a well-publicized International Meet every 2 years. Additionally, we would reap a financial reward every other year instead of every 3<sup>rd</sup> and lessen some of the congestion of previous Triennial meets.

There is an important meet in July, the OPS meet, that is displaced by the traditional timing of the Triennial to end near the 4<sup>th</sup> of July. There should be a way to rearrange our Meet schedules to provide for both meets with a Biennial transformation. One idea could be to incorporate the OPS meet within the Biennial meets. Let's use those thinking caps we've become so good at utilizing.

The other argument why we can't do this event any sooner than every 3 years is “we don't have the volunteers”. Hogwash. The theme last year was “Ask and They will Volunteer”. They did! A record number of people showed up to man those committees and some were dedicated enough to do so all week long. More members are moving to or putting a 2<sup>nd</sup> residence near the Chiloquin area as they retire. That will benefit our club and relieve some of the “overworked locals” situation as well.

On the fiscal side of this issue, more improved track is a concern. We have been in a continual track renovation mode since 2015. It's paying off with much of the wood ties being replaced along most of the south side. This process costs money and how best to make money?

Hold an international Event every other year. The number of trains, cars and visitors should go down to a volume we can handle with continued participation from attendees as volunteers. We'll still have a great collection of trains for everyone to enjoy but get much needed funding more often.

Unfortunately, it is probably not realistic to implement the Biennial in 2020. Therefore, an International event held in 2021 will be just as hectic. Publicizing a change to Biennials, effective in 2023, could be advantageous. Then, if someone can't attend in 2021, they only need to wait until 2023 to join the greatest meet in the hobby!

**Register to attend a Train Mountain Meet Now!**

# What Is IFPL?

By Jeff Mills

IFPL is the acronym for Industrial Fire Precaution Levels. These levels are applicable to industrial work performed in forested areas and pertain primarily to the use of power equipment or activities that might produce sparks or fire. IFPL limits the hours of operation for industrial type work and provides limits to what kind of work can be performed. They can require FIRE WATCHS after approved work is completed.

How do these levels apply to TMRR? The primary application is to the employees of Train Mountain Institute as they are the primary operators of powered equipment. When IFPL level 1 and higher is in effect, regulations require members to carry firefighting tools on their trains.

These levels are generally posted in Roman Numerals and are on the same sign with the Adjective "Fire Danger Level." They may seem counterintuitive so please read carefully. There are three Adjective "Fire Danger Level" signs on the Train Mountain property, please be aware of these signs. They are a reminder of the potential danger of fire and the precautions we need to take.

## Level I

Closed season; meaning Fire season has been declared and all Fire Season related rules are in effect.

## Level II

Partial Hoot Owl ; All Industrial activities must take place between 8:00 PM and 1:00 PM followed by a fire watch after work is halted.

## Level III

Partial Shut Down; Prohibited activities Power saws, Cable Yarding. Permitted activities between 8:00 PM and 1:00 PM \* (see further explanation below); tractor skidder operations when equipment being used has a blade capable of cutting a fire line. Mechanized loading or hauling of any product or material; blasting, welding or cutting of any metal, or any other activity which may cause sparks. These permitted activities must be followed with a fire watch at completion of work.

## Level IV

General Shut Down; All operations are prohibited.

\*The hours of permitted activities under Level III start in late evening through the night and into the following morning halting at 1:00 PM. These are the hours of the day when the accidental starting of a fire is at its lowest point. Generally after noon the temperature is increasing along with a drop in humidity followed with an increase in wind velocity.

More information can be found on the TMRR website. Click the tab "Safety at TM", then click "Fire Equipment Self Inspection Form". This document explains the fire watch and required equipment for all Industrial Operations covered by the IFPL.

As fire danger levels increase, our vigilance and awareness must also gear up. Everyone must be on constant FIRE WATCH while at Train Mountain.



**Register to attend a Train Mountain Meet Now!**



## FIRE SEASON TRAIN MOUNTAIN 2019

By Jeff Mills

This late spring is laying down its last snow and rain. Soon the warmer weather will be here. This means we need to renew our diligence in FIRE PREVENTION and Detection. We have had more snow this year than in the past few years. It is good when it melts slowly and soaks into the ground. This raises water table levels and allows the plant life to take a long needed drink. It also means the vegetation will have a good growth spurt, shedding dry pine needles, pine cones and other forest debris which provides dry fuel for a wildfire. Raking the track and drainage ditches becomes as important as ever. This clearing of fuel around the track is one the best fire prevention activities we perform on a regular basis. As usual, awareness of the fire danger signs and understanding of what they are indicating is also vital.

For obvious reasons, smoking is **not** allowed out on the tracks and will only be tolerated in 3 designated smoking areas. These areas are on the east side of central station Hall Of Flags entrance, the east side of the back shop and the man door at the motor pool. Please be watchful for people smoking in non-designated areas and either ask them to extinguish their cigarettes or report the infraction to the office.

This is also the right time to check out your own firefighting equipment. Fire tools that are required are a Pulaski, shovel, gallon of water or fire extinguisher. Ensure the tool heads are sharp and free of rust, check handles for cracks or loose heads and correct any faults now. When you need the tools, it is too late to fix them. Fire Extinguishers need to be checked for charge and date of manufacture. If the extinguishers are not charged, they need to be recharged or are 6 or more years old, replaced. I will be preparing the Fire Gondolas for deployment during the Narrow Gauge Work Week and will be looking for a few volunteers for help with this. I encourage the addition of these fire gondolas to all work trains and to any other trains adding to their consist.

When operating on the railroad, all persons should consider themselves on Fire Watch as early detection and suppression is the best system to prevent a catastrophic fire.

### **Railroad Haulers (AKA trailers etc)**

The Narrow Gauge Meet brought out a problem that we have a solution for but have got lazy in the enforcement department. The problem is that little parking area adjacent to the Motor Pool building and across from Blue Caboose is parking AUTOMOBILES that belong to the members staying Blue Caboose. It was NEVER intended to be railroad trailer parking. PLEASE park your trailers down below, either on the Service Road or Katy Lane or Molly Lane. Thank you.

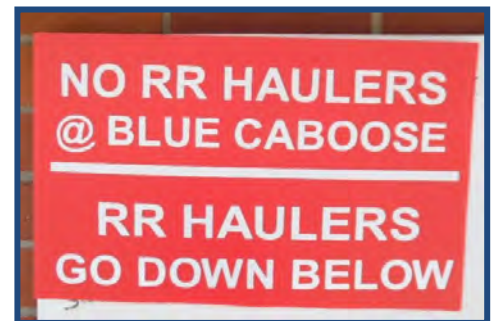

**Register to attend a Train Mountain Meet Now!**

**The Mountain Gazette**

Page:8

**June 2019**



## SOS! From your store lady, Delores Bartholomew. UPDATE ON THE AED:

Central Station is ready for an emergency! The AED is attached on the wall by the restrooms. You can't miss it! Our THOUSAND THANK YOU'S TO ALL WHO CONTRIBUTED SO QUICKLY! However we have another problem at TM. Ideally you want to get to an AED and back to the person in need within 3 to 5 minutes.

This is a major problem at TM. We need an AED in every building, because of the great distance between buildings. So we are asking you, TM members, to consider digging deeper into your pockets and help purchase at least two more AED'S, one for the Back Shop and one for the Track Shop.

A bit of education for ALL of us in regards to this reasoning.

***"We should have an AED in every place we work, play, or pray."***

Mary Tappe, an advocacy group, Iowa AED Access for All Sudden cardiac arrest is result of an arrhythmia, in which the electrical pulse of the heart goes out of control, causing the heart to quiver. Doctors don't understand why this happens, but they do know that shocking the fibrillating heart is the only effective treatment. An estimated 350,000 people in the US die each year from it---that's more than cancer, car crashes, house fires, and handguns combined. Mary's heart stopped beating on May 17, 2004. Mary ,47, walked into a work meeting, sat down, and fell over. A retired nurse started CPR and another grabbed the AED. Within 3 minutes of her collapsing, the AED shocked Mary's heart twice to help it return to normal rhythm.

The survival rate for people who have sudden cardiac arrest is about 5-7 %. Those odds rise to 70-80 % when a person is shocked with a public-access AED or one used by a paramedic. "For every minute a victim is down, her chance of survival is reduced by 10 percent," Mary says. So within 10 minutes, you have little or no chance for survival." IDEALLY, you want to get to an AED and back to the person in need within 3 to 5 minutes.

Just think about where you spend your time at TM and if you might be the VERY ONE that needed the AED, but they couldn't get to you in time. IS YOU LIFE WORTH \$3,000!?

The public is also donating, but in small denominations. Our donation box is still in Central Station and we have \$1,000 at present, but our goal is \$3,000 more to purchase two more AED's for the distant buildings. We know this is stretching in asking for more, but a life is worth every penny.



Thank you, Thank you, Train Mountain Members, you are the BEST!



Register to attend a Train Mountain Meet Now!

# Banquet Ticket Sales

It is very important to purchase your Meet Banquet Tickets by Noon on the Friday before the Meets Saturday Banquet.

We must get the number of attendees to the caterer to make sure there is enough food to feed everyone.

If you plan to arrive on the Friday of a Meet, please call the TMRR Office during business hours and provide your name and number of guests so we can add those to the attendee count.

We want everyone to have the opportunity to attend

**This is your newsletter!**

**Thank you to everyone that took the time to submit articles this month.**

**Please keep it up!**

**WE ARE ALL VOLUNTEERS**

**DON'T YELL AT ME, I AM A VOLUNTEER!**

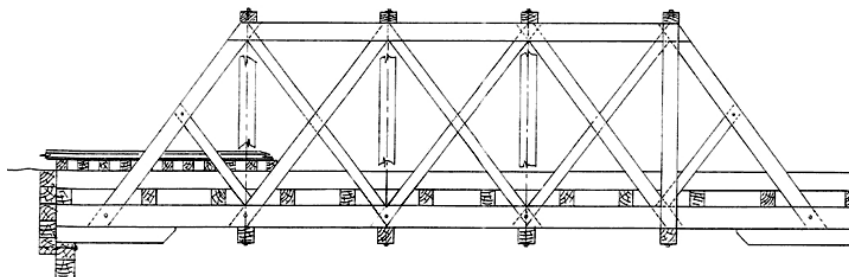

Please Volunteer at a Train Mountain Meet!

## Train Mountain Railroad and Sleep Inn Hotel

Sleep Inn is the new hotel located next to the Casino in Chiloquin. The manager is **Mr. Ellsworth** and he has worked with Train Mountain for several years in his past capacity as manager of the Travel Center. The Front Desk number is 541-827-5300. He has stated that the 2019 season is already getting booked so if you would like to stay at the Sleep Inn I would strongly suggest you make your reservations now. Make sure you inform them you are a Train Mountain member to get the best rate. It is a brand new facility and has lots of great amenities not the least which is they are just across Hwy 97 from the park.

Amenities include:

- Free WiFi
- Free breakfast
- Meeting space
- Fitness center
- Indoor heated pool

Guest rooms feature:

- Refrigerator and microwave
- Premium bedding
- Work desk
- Flat-screen TV
- Coffee maker

Sleep Inn & Suites® hotel offers easy access to a variety of local attractions, including the Kla-Mo-Ya Casino and:

- Crater Lake National Park
- Klamath Falls
- Train Mountain Railroad Museum
- Klamath Marsh Wildlife Refuge
- Collier Memorial State Park

Front Desk number is 541-827-5300 ask for the Train Mountain discounted rate.



September 4-7, 2019  
Sacramento, CA

## 2019 National Narrow Gauge Convention *An Invitation to Participate*



We west coasters are putting together a 2.5" (1.5", 2.5", 3.75") extravaganza at the 2019 NNGC to be held in Sacramento, **Sept. 4th-7th, 2019.**

We would love for you to attend with equipment if possible. All the usual suspects are planning to attend. I hope to have 20 ish engines running during the convention. We are listed on the official convention layout tours and will be at the Sacramento Valley Live Steamers in Rancho Cordova.

We plan to give rides to conventioners on **Sept. 4th and 5th.** Let me know if we can save you a steaming bay!!!

Contact me with any questions.

**Ken Burns** ([rgsken@sbcglobal.net](mailto:rgsken@sbcglobal.net))

Camping will be available at the track for participants.

Hope to see you there.

Please Volunteer at a Train Mountain Special Event!



# I AM NOT A ROBOT!

There have been a few changes made to the member's site, specifically where payment information is entered. The most noticeable change is that we have added a question asking if you are a robot. You check the box and depending on a bunch of things, you may be asked to choose from a set of pictures. You may be asked to click the pictures that show street signs, or click on pictures that show store fronts. It seems silly, but the questions and challenges are carefully crafted and updated by Google, and have an amazing success rate at determining if the entity pressing the keys is a real person or a computer program ("robot") trying to gain access.

The technology is called "CAPTCHA", or in our case "reCAPTCHA" and is quickly being the standard for online protection against robots, which pose a real problem to web sites. This is replacing the (to me) very irritating practice of trying to figure out what letters and numbers they are showing in fuzzy text. If you have questions or problems getting around the new challenge (or if you are a robot!), feel free to give Joyce a call in the office.

Dale Furseth, "the computer guy"

## Volunteer Hours Reporting

Dale Furseth has worked his techie magic on the member's part of our website again. You can now report your monthly volunteer hours online. From the Train Mountain Railroad home page, click on "Online Member Resources: Join Train Mountain: Register for Meets", then on "Enter Volunteer Hours" or go there directly with this link:

[https://trainmtn.org/tmrrmembers/Member\\_VolunteerHours.aspx](https://trainmtn.org/tmrrmembers/Member_VolunteerHours.aspx)

Choose your name from the drop down menu, enter your total hours in the box that matches the month you are reporting your hours for and click on "Update Information" to submit them. So-o-o simple! We hope you enjoy using this new feature.

**Please submit your volunteer hours. If you work off site or at home on Train Mountain projects - these hours count.**



**REMEMBER: No job is complete without the paperwork!**

## **Weed Spray Train Crews Needed**

### *Repeated Request*

This request from Boyd and crew is a function that must be done to maintain our park. Please reread this request and give us a hand if you can.

Train Mountain has an extensive weed control program. We have a dedicated weed control train as well as a dedicated weed control 'gator. For the past several seasons Boyd Butler and Bill Kludt have operated the equipment. Now both members feel that the equipment is sufficiently well developed that the general membership can participate.

The weed management season coincides with the TM organized meets season: the Spring Awakening Meet until the Fall Colors Meet. Generally one pass over the railroad per work week is sufficient. Different volunteers can arrange to do one or more sessions.

Members interested in participating should contact Boyd Butler directly. You will receive thorough on-the-job training and Boyd will be available to provide supplies, parts and repairs.

This is a neat opportunity to contribute to TM in a big way while running an interesting train. Arrangements to use a TM loco on the train are possible. You get to see all the railroad while contributing a much needed service.

## **Train Mountain on Oregon Public Broadcast Links**

The new segment on Train Mountain and other Oregon destinations was aired in their Thursday, November 9th broadcast of Oregon Field Guide. You can now view the entire segment directly on the opb.org website here: <https://watch.opb.org/video/3006578129/>

OPB has made the Train Mountain part of the broadcast available on Facebook.



# NOTICES

## **Gazette PUBLICATION DEADLINE:**

Submissions to the Gazette must be received by the 15th of the month of publication. The fifteenth of the month is to be the last day to submit material. Material received after the 15th of the month may be held until the following month or rejected.

### **SUBMISSION CRITERIA**

Articles and ads may be submitted via a pdf file, MS WORD, Open Office, notepad, or similar text file attached to an email. The email SUBJECT line must include your article title and a date.

Please give each article a distinct file name with your name and a date. If everyone submits an article named "article for gazette" or something similar it will often get overwritten by another article with the same name when downloading. Articles sent as text in a email text will no longer be accepted.

Please use a common open source FONT such as ARIAL that can be displayed in all Browsers, and is easy to read. Please do NOT use the Calibri font, as we must take the time to convert it to Arial.

If your document has an embedded image, you must also include the image separately as a jpg,

## **Visitors to Train Mountain and YOU:**

Train Mountain is very popular and is continually attracting visitors from throughout the world. We announce that our hours are from 9:00 AM until 3:00 PM Monday through Friday during the summer, and 10:00 AM to 2:00 PM during the winter. The office is closed on weekends except during meets, and then only when volunteers are available to open the office.

Our insurance advisors request that all people (members and visitors) complete and sign a liability release. If **YOU** as a member encounter visitors on the property without a visitors pass please direct them to the office so that we can insure that a release has been completed and a visitors pass has been issued.

If **YOU**, as a member, open the gate and allow visitors to pass through - **YOU** are responsible to see that the release has been completed, and **YOU** are liable for them until they sign a release. Releases are available in the mailboxes near the office for those times when the office is closed. There are also releases available in the kitchen and in the Back Shop.

***If you do not want to, or do not have the time to, ensure that the releases are completed*** - then please graciously explain that the train park is closed to visitors and that the open hours are normally (Winter - 10:00 AM until 2:00 PM) (Summer - 9:00 AM until 3:00 PM) Monday through

**Please Volunteer at a Train Mountain Meet!**



## **Train Mountain is a NO SMOKING Facility**

**During recent events, many Members and their Guests have been ignoring this policy. There are only three designated smoking areas at Train Mountain:**

- (1) Outside the front of the Backshop**
- (2) Outside the east door of the Hall of Flags**
- (3) Outside the Motor Pool (Maintenance Building)**

**Due to the high fire danger at Train Mountain during the summer, we have zero tolerance for anyone smoking outside one of the designated areas.**

**There is NO SMOKING anywhere out on the track!**

**Members, Guests, and Visitors that continue to violate the Train Mountain Smoking Policy may be asked to leave.**

## **What is Amazon Smile?**

In a nutshell, it is a way for Train Mountain to receive 501c3 donations from Amazon. According to Amazon: AmazonSmile is a simple and automatic way for you to support your favorite charitable organization every time you shop, at no cost to you. When you shop at smile.amazon.com, you'll find the exact same low prices, vast selection and convenient shopping experience as Amazon.com, with the added bonus that Amazon will donate a portion of the purchase price to your favorite charitable organization. You can choose from nearly one million organizations to support.

When you go to Amazon Smile, choose Train Mountain Institute as your charity. In order for this to work, you must always start from Amazon Smile. Then all else is the same, your account, wish lists, etc. Also available is a direct link: <http://smile.amazon.com/ch/27-4031025> for the TMI account.

The AmazonSmile Foundation will donate 0.5% of the purchase price from your eligible AmazonSmile purchases. I found that just about everything I purchased lately is eligible.

If we can get a large number of Train Mountain supporters to take advantage of the Amazon Smile program, this could result in sizable donations to Train Mountain.

Click here for more information.

## **Gate Code**

**Due to security concerns, the Gate Code for the Train Mountain Main Gate may be changed at any time without notice. Any Member planning to arrive at Train Mountain when the Office is closed will need to contact the Office prior to arrival to ensure they have the current Gate Code.**

**The Gate Code was changed on July 12, 2018**

# LILLYVILLE FAKENEWS TABLOID

Seymour Skandles - Editor



## NEW CHURCH

The Reverend Dale E. Bread believes that Lillyville is closer to "being saved" now that there is a church in town.

Church volunteer, Brighton Early, now rings the church bell every morning at dawn.

Attendance is great, except for the "heathen" men that refuse to attend until their saloon is rebuilt.

## What Happened to the Saloon?

Anna Mosity, head of the temperance movement, is overly elated following the collapse of the Beer Thirty Saloon last winter. She is blaming the heavy snow. The men blame the temperance movement after they discovered none of the alcoholic beverages could be recovered as all the bottles had been smashed.

Saloon spokesman Al Coholic hopes attorney Lou Pole will get the insurance company to pay the replacement costs of the lost stock and collapsed building.

Duncan Disorderly and Donny Brook have been fighting in the spot where the saloon used to be. They claim it's just nostalgia.

## Stage Coach Service

The Wells Fargo and Express Company stage coach service to Lillyville is in full operation. The Stage Coaches are delivering passengers and mail regularly.

Baggage employees, Carrie Case, and Kerry Erbag are there to help passengers with their luggage. Rick Shaw's local taxi service is still running.



## Construction on Mallery's Completed

According to Jim Shorts, speaking for the owners of Mallery's Bath House, employees Anita Shower and Anita Bath will attend to your bathing needs.

## New Jail

Abel Carpenter of the Eakin Construction Company recently completed the new Lillyville Jail.



LILLYVILLE  
CONSTRUCTION BOOM  
TO CONTINUE FOR  
THE FORESEEABLE FUTURE

Bear  
Sighting  
near  
Lillyville





# WEB-CAM GALLERY

Photos by: The Web-Cam





# WEB-CAM GALLERY

Photos by: The Web-Cam





# WEB-CAM GALLERY

Photos by: The Web-Cam





# WEB-CAM GALLERY

Photos by: The Web-Cam





# WEB-CAM GALLERY

Photos by: The Web-Cam





# WEB-CAM GALLERY

Photos by: The Web-Cam







# CLASSIFIEDS

## 2018 Triennial Video Now Available

The 2018 Train Mountain Triennial video from Aaron Benson at 7Idea Productions is now available. You can order online at the link shown or you can call the office at 541-783-3030 to get your copy. This is a most enjoyable video created by a true video artist and of course it just happens to be about our most favorite subject! The cost of the video is just \$29.95, quite a bargain!

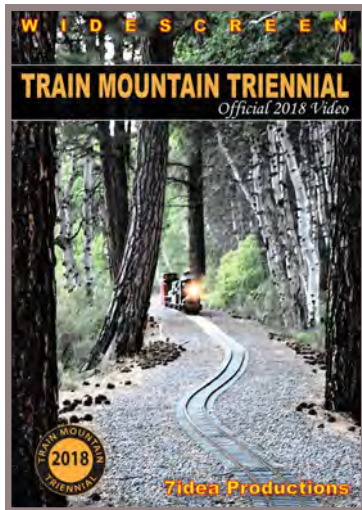

Our good friend Jim over at Discover Live Steam has placed ads for us on his terrific website, thanks Jim. [discoverlivesteam.com](http://discoverlivesteam.com)

Did you see the great article and front cover story from the January / February 2019 issue of Live Steam and Outdoor

Railroading? It is a great article covering the 2018 Triennial. and the great gang of folks that hang around the place and put on terrific live steam trainmeets. As an added bonus there is a photo album by member Michelle Moore! How about that! Pretty cool!

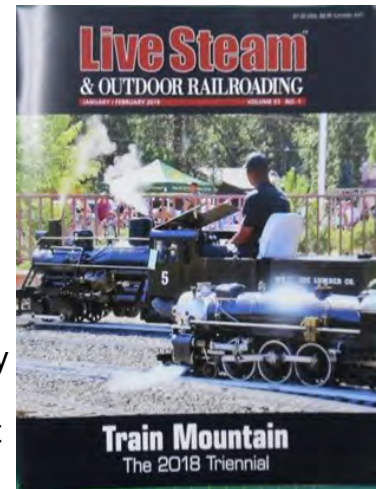

### HAVE SOMETHING YOU WANT TO SELL?

Place an ad in the Gazette!

1/8 Page: \$25/month or \$250/year

1/4 Page: \$40/month or \$400/year

1/2 Page: \$70/month or \$700/year

Full Page: \$125/month or \$1250/year

Published by Train Mountain Railroad

P.O. Box 438

Chiloquin, OR 97624

Email: [info@tmrr.org](mailto:info@tmrr.org) Phone: 541-783-3030

Contributors: TMRR BOD, Friends, TMI

Photos: Tom Watson



Please Volunteer at a Train Mountain Meet!



# CLASSIFIEDS

Castings, frames, and new boiler available for 18" gauge locomotive. This is modeled after the locomotive at The Nut Tree Railroad in Vacaville, CA. This stuff belongs to Fred Kepner, who lives off the grid and is difficult to contact. He is asking \$9500, OBO. Anyone seriously interested, can email Tom at [twatson703@gmail.com](mailto:twatson703@gmail.com), and I can email you the history of these parts and how to contact Fred



## THE POTBELLY CAFE



Located only 1.5 miles off Hwy 97 in Downtown Chiloquin in the same building as the Post Office 212 1st Avenue, Chiloquin, OREGON 97624 -- Phone: (541) 783-0988



**Good Service**  
**Good Food**  
**Friendly Folks**



## Crater Lake/ Train Mountain Vacation Rentals

### Crater Lake Chalet

Located on Hwy 422, only 1 mile off Hwy 62 and 2 miles from Hwy 97 in the Chiloquin area. This house is at north end of Train Mountain and contiguous to Train Mountain.



This comfortable house sits on 35 beautiful acres. 2 bedrooms and 2 bathrooms. Can sleep up to 6 people.

### Panoramic View Ranch House / Crater Lake



This ranch house is located on Hwy 62, and attaches to the west side of Train Mountain. The 56 acres of land features panoramic

views of Agency Lake and the Cascades. Enjoy a peaceful and private experience. 4 bedrooms and 2 bathrooms.

Can sleep up to 8 people.

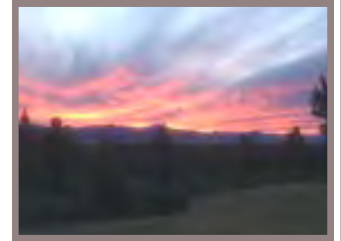

For more information please call: **Julie 415-756-3943** or **Mike 415-420-9026**  
**10% off for train mountain members**

## Crater Lake Junction Travel Center

34005 Hwy 97 N, Chiloquin, OR 97624, 541-783-9800

The Crater Lake Junction Travel Center opened for business in 2010, and is owned by the Klamath, Modoc and Yahooskin Tribes. Open 24 hours a day and located just next door to Kla-Mo-Ya Casino as you enter, this travel center offers competitive fuel prices and many convenience items. Travelers can fuel up with gas, diesel, or propane. Stop in for a snack or soda, or grab a quick meal featuring Mexi-Go or Mountain Fresh Pizza. Free Wi-Fi, a comfortable lounge with large screen TVs, laundry and shower facilities, and ATMs are all available.

Make sure to ask for a Crater Lake Junction Travel Center rewards membership card so that you can earn points for each purchase and visit. Your earned points can be applied toward future purchases. Truckers, ask about trucker services and benefits for each visit. Convenience items and truck accessories are for sale, along with many useful daily provisions.

**Come enjoy the warmth and excitement of Kla-Mo-Ya casino.**

### Crater Lake National Park

Crater Lake National Park is located off Highway 62, just 34 miles from Kla-Mo-Ya Casino and the Crater Lake Junction Travel Center. After playing and fueling up, discover the world-famous beauty and amazing history of Crater Lake. Groups and parties, ask about casino shuttle service for your outing or adventure.



# Seenager

I **JUST** discovered my age group! I am a **Seenager** (senior teenager).

I have everything that I wanted as a teenager, only 55-60 years later. I don't have to go to school or work. I get an allowance every month. I have my own pad. I don't have a curfew. I have a driver's license and my own car.

I have ID that gets me into bars and the wine store. I like the wine store best. The people I hang around with are not scared of getting pregnant, they aren't scared of anything, they have been blessed to live this long, why be scared? And I don't have acne. Life is Good!

Also, you will feel much more intelligent after reading this. If you are a **Seenager**. Brains of older people are slow because they know so much. People do not decline mentally with age; it just takes them longer to recall facts because they have more information in their brains. Scientists believe this also makes you hard of hearing as it puts pressure on your inner ear.

Also, older people often go to another room to get something and when they get there, they stand there wondering what they came for. It is **NOT** a memory problem; it is nature's way of making older people do more exercise.

## **SO THERE!**

I have more friends I should send this to, but right now I can't remember their names. So please forward this to your friends; they may be my friends, too.